

# PROVISO TOWNSHIP HIGH SCHOOLS DISTRICT 209

Community Engagement Session #4

APRIL 24, 2018



## COMMUNITY ENGAGEMENT SESSION #4

### Agenda

#### Goals & Objectives:

*To review progress to date and receive input on master plan components*

**01 /** Opening Statements, Introductions

**02 /** Process to Date

**03/** Expectations & Process

**04 /** Concept Development

**05 /** Gallery Walk

A photograph of a school courtyard. In the foreground, a large tree trunk is on the left. A paved walkway leads from the bottom center towards the right. In the middle ground, there is a semi-circular arrangement of white bleachers on a paved area. Behind the bleachers is a brick building with a light blue section featuring a mural. The sky is blue with white clouds. The overall scene is bright and sunny.

# 01/ INTRODUCTIONS

# PROVISO TOWNSHIP HIGH SCHOOLS DISTRICT 209

## FACILITY MASTER PLAN COMMUNITY ENGAGEMENT SESSION 4



# WELCOME!

*APRIL 24, 2018*



# MISSION



To provide the highest quality education, where learning, leadership, service, and research-based practices ensure equitable and meaningful opportunities for all students.

PROVISO TOWNSHIP HIGH SCHOOLS DISTRICT 209

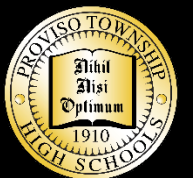

# VISION



Through expectations of excellence and by providing equitable educational opportunities to empower each student, our graduates are prepared for college, careers and to serve as contributing members of a dynamic global society.

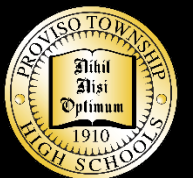

# GOALS



**ENHANCE ACADEMIC ACHIEVEMENT**



**EMPOWER STUDENTS, FAMILIES, AND COMMUNITIES**



**ENSURE EFFECTIVE AND EFFICIENT OPERATIONS**

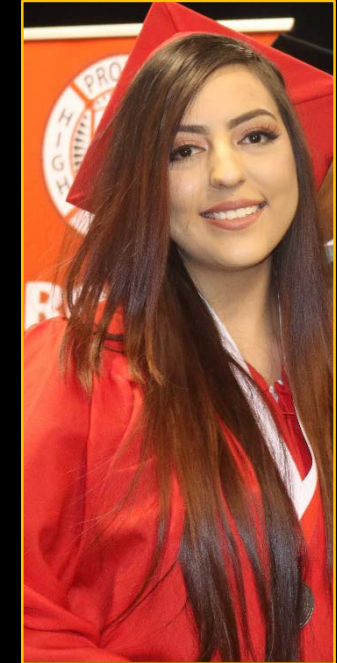
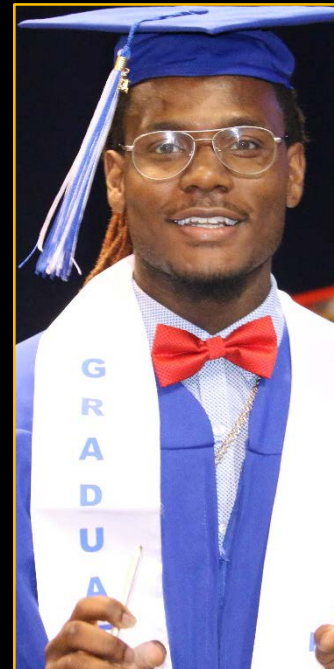
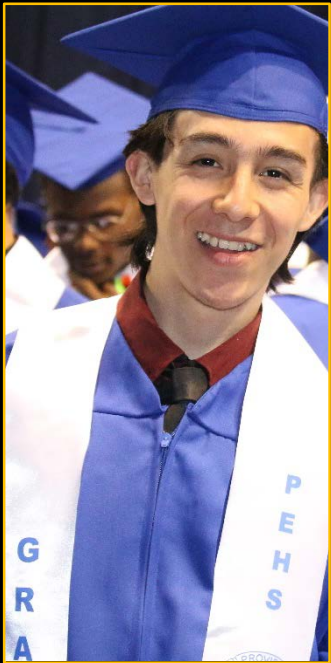



# PROVISO TOWNSHIP HIGH SCHOOLS DISTRICT 209

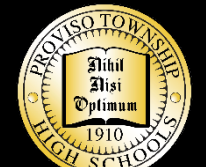





PROVISO TOWNSHIP HIGH SCHOOLS DISTRICT 209



# D209 BOARD OF EDUCATION AND ADMINISTRATION

Theresa L. Kelly President	Amanda J. Grant Vice President	Claudia Medina Secretary	Rodney Alexander	Arbdella "Della" Patterson	Samuel Valtierrez	Ned Wagner
						

Jesse J. Rodriguez Superintendent	Dr. Kim Echols Assistant Supt.	Dr. Nicole Howard Assistant Supt.	Mr. Todd Drafall CFO/Business	Dr. Patrick Hardy Principal, PEHS	Dr. Bessie Karvelas Principal, PMSA	Dr. Nia Abdullah Principal, PWHS
						



# \$28 MILLION HEALTH LIFE SAFETY \$100+ MILLION IN CAPITAL NEEDS



PROVISO TOWNSHIP HIGH SCHOOLS DISTRICT 209



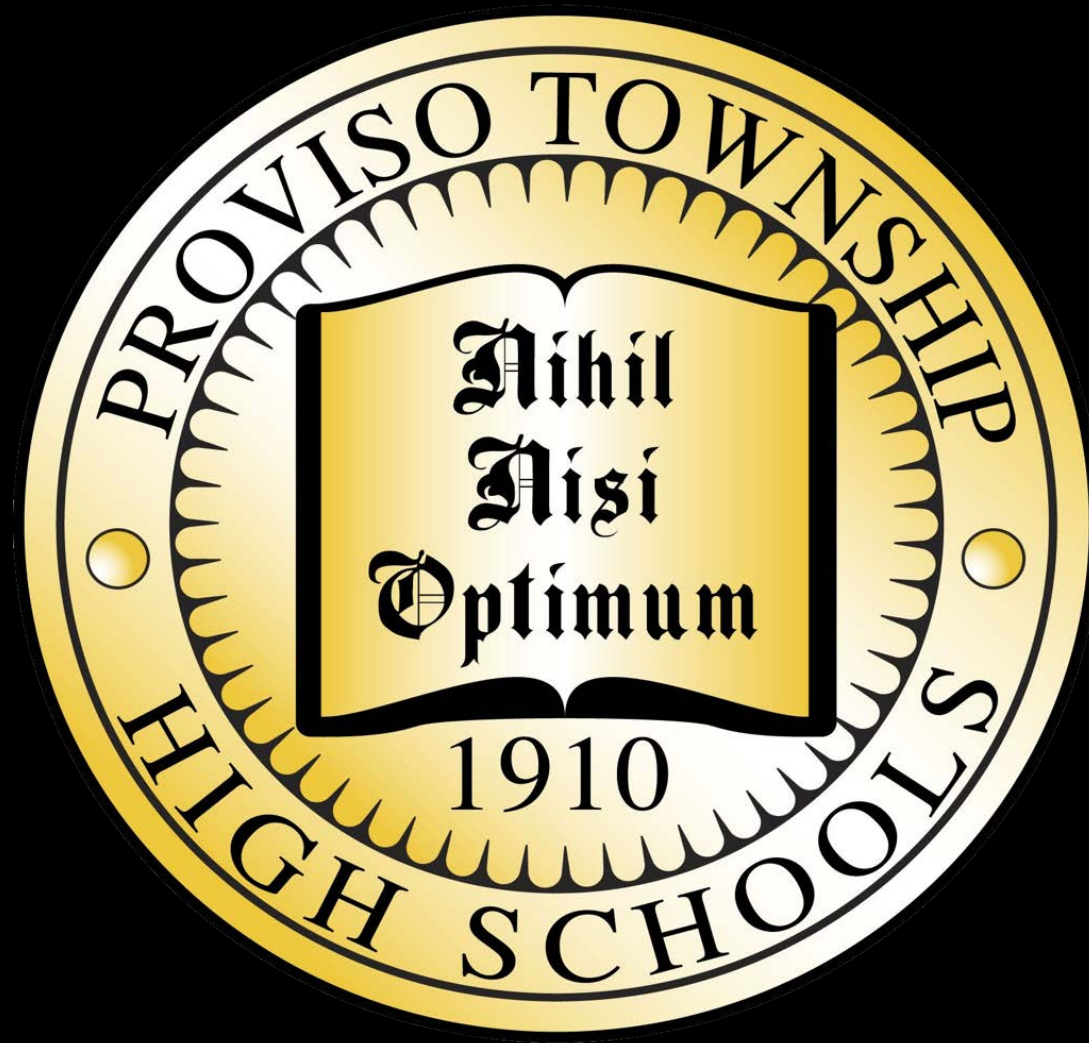

ONE TEAM, ONE GOAL, ONE PROVISO

**PERKINS+WILL**



**MICHAEL DOLTER**



**MARK JOLICOEUR**



**JESSICA WAGNER**

PERKINS+WILL



P E R K I N S  
+ W I L L

LEADERS IN  
EDUCATIONAL DESIGN  
SINCE 1935 /

2,500+ Pre-K-12 projects

Ranked Top K-12 design  
firm nationally by  
Architectural Record

185+ professionals in  
Chicago office

Over 600,000 students  
served & counting

More national AIA Honor  
Awards for K-12 schools  
than any other firm

Deerfield High School  
Deerfield, IL



**02/ PROCESS TO DATE**

# FACILITIES MASTER PLANNING PROCESS

Revised Community Engagement Schedule

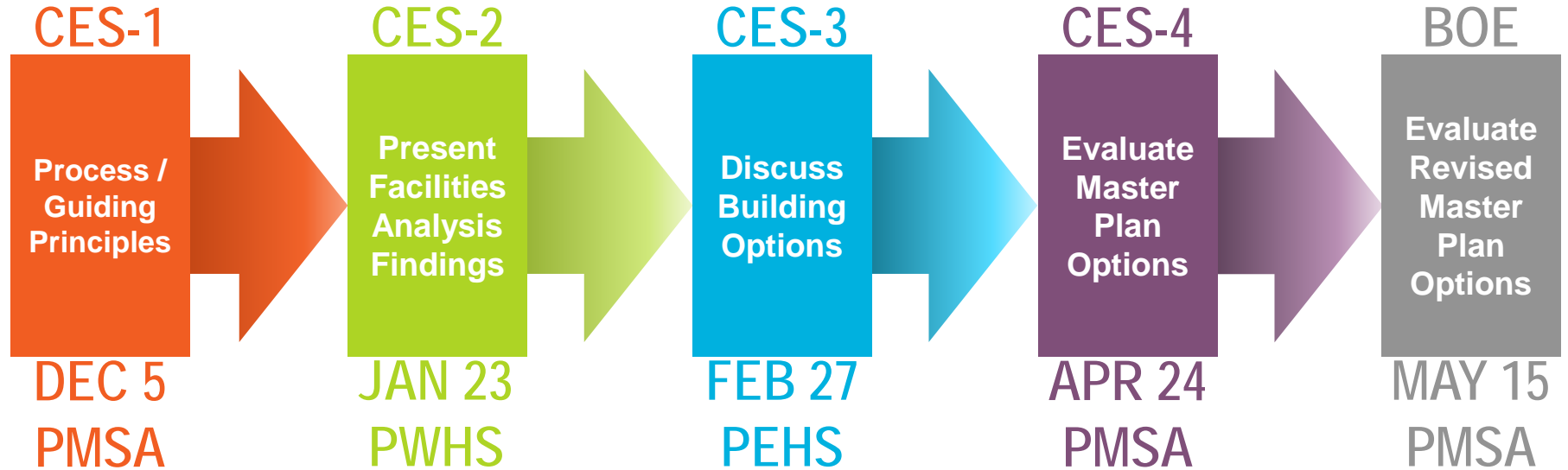



# COMMUNITY ENGAGEMENT SESSION #1

Recap - Process



What is a Master Plan  
...and why do it?

Master Plan  
Guiding Principles

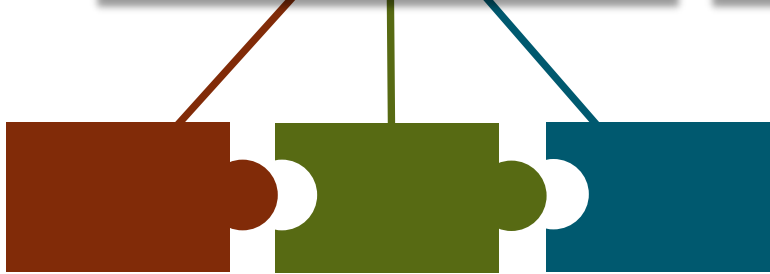

# WHAT IS A FACILITIES MASTER PLAN AND WHY DO IT?

## What

- Road map for the future
- Not a final plan, but a long-term strategy
- A living document

## Why

- As stewards of Proviso Township High Schools District 209's educational and financial resources, this process allows you to develop a plan that:
  - Reflects community priorities
  - Projects future investments
  - Establishes a timeline for implementation
  - Utilizes taxpayer funds wisely



# FACILITIES MASTER PLANNING PROCESS

What is a Master Plan? And why we do it?



# MASTER PLAN GUIDING PRINCIPLES

All Master Plan Decisions should...



# COMMUNITY ENGAGEMENT SESSION #2

Recap - Analysis

## Qualitative

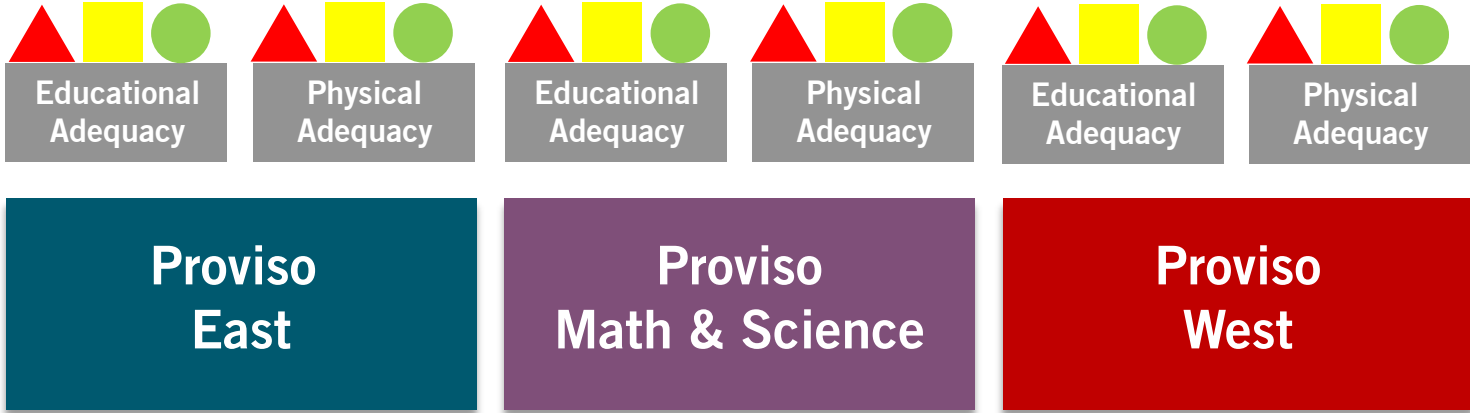

## Quantitative

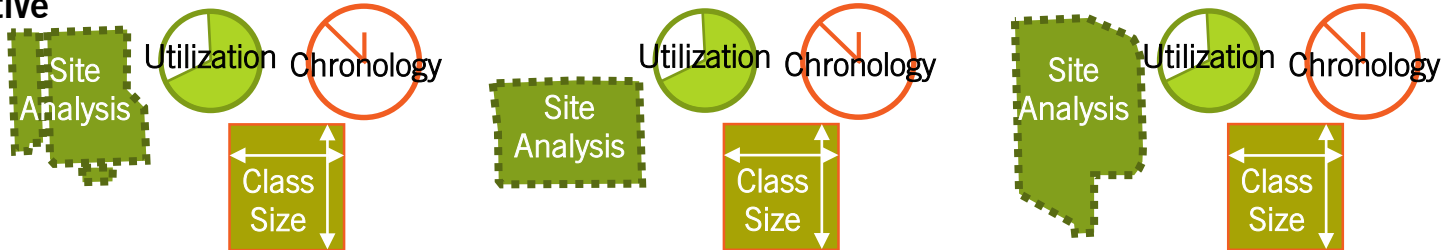

<b><u>Statistics Comparison</u></b>	<b>Proviso East High School</b>	<b>Proviso West High School</b>	<b>Proviso Math &amp; Science Academy</b>
Site Size	<b>46 Acres</b>	<b>55 Acres</b>	<b>8.5 Acres</b>
Building Size	<b>499,020 sf</b>	<b>550,000 sf</b>	<b>225,000 sf</b>
# Students	<b>1,814</b>	<b>1,850</b>	<b>790</b>
Area per Student	<b>275 sf</b>	<b>295 sf</b>	<b>285 sf</b>
Classroom Utilization	<b>67.3%</b>	<b>64.7%</b>	<b>64.0%</b>
# Science Classrooms	<b>9</b>	<b>13</b>	<b>8</b>
# Special Education Classrooms	<b>13</b>	<b>24</b>	<b>0</b>
# Other Classrooms	<b>70</b>	<b>69</b>	<b>33</b>
Average Size – Science Classroom	<b>1128 sf</b>	<b>869 sf</b>	<b>1519 sf</b>
Average Size – Standard Classroom	<b>712 sf</b>	<b>731 sf</b>	<b>944 sf</b>



CES-2

Present  
Facilities  
Analysis  
Findings

JAN 23  
PWHS

**CES-2 Key Community Question:**  
**AS A DISTRICT, WE HAVE MANY EXCELLENT  
PROGRAMS, BUT DO WE HAVE TOO MUCH  
SQUARE FOOTAGE FOR OUR STUDENT  
POPULATION?**



# COMMUNITY ENGAGEMENT SESSION #3

Recap – Focus on Facilities – Conceptual Ideas

Maintain 3 discrete campuses



Co-locate a PMSA academy at both East & West

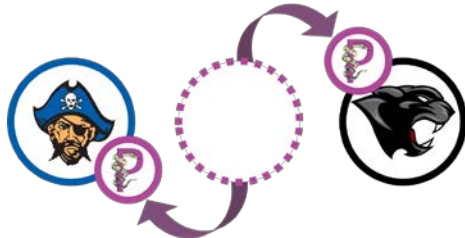

Co-locate a PMSA academy at either East or West



Re-merge the PMSA program Back into West & East



PMSA program moves to West, West & East merge as Proviso High School







## 02/ CONCEPT DEVELOPMENT & DISCUSSION

# MASTER PLANNING

Exploring Concepts

## Where are we today?



Understanding  
Needs

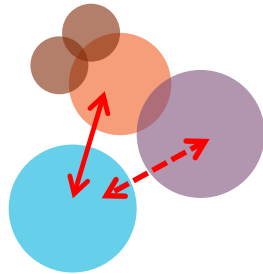

Defining  
Relationships

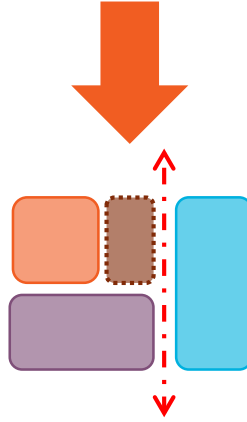

Concept  
Testing

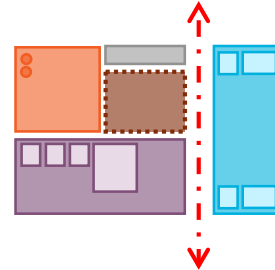

Concept  
Refinement

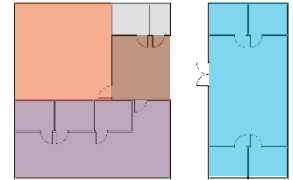

Plans &  
Details



# MASTER PLANNING

## Example Timeline

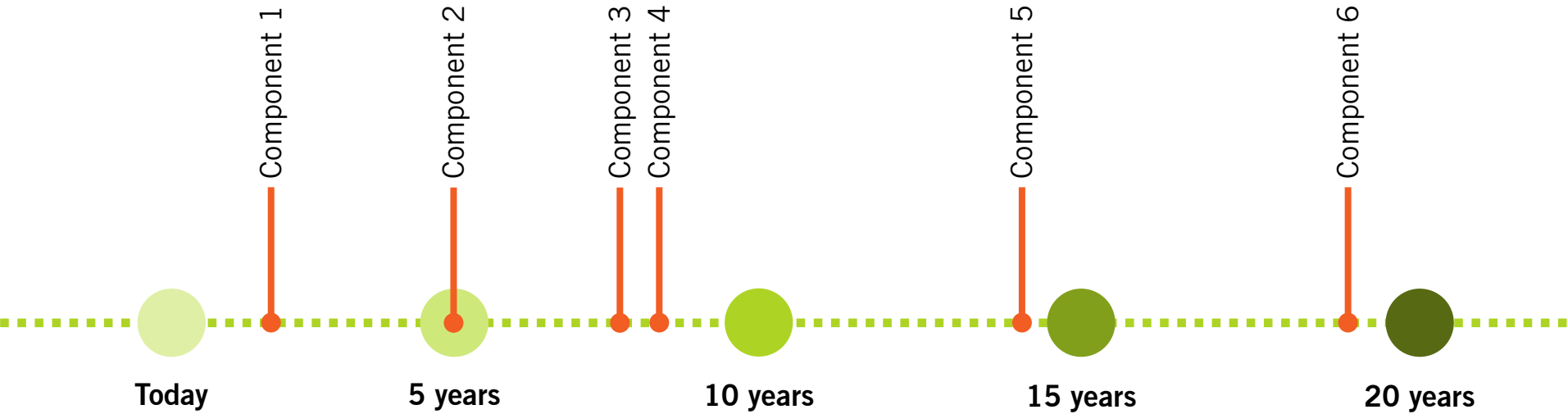

PMSA  
EXISTING



# PMSA

# 1



Relocate lot entry further north and provide additional drop-off/pick-up area for ease of access and safety

Provide open play field, walking track and tennis courts for physical education use

STUDENT PARKING  
213 SPACES

PLAY FIELDS WITH WALKING TRACK

PICK-UP / DROP-OFF

GYMNASIUM

New, dedicated drop-off/pick-up lane lowers congestion and creates safer site circulation

FACULTY / STAFF PARKING  
143 SPACES

LOCKER ROOM LOCKER ROOM

PERFORMING ARTS ON 2ND FLOOR

New PE facilities, re-dedicate facilities in main building for additional classrooms; potential 2nd floor performing arts facilities

New Student Commons with relocated secured entry allows for after hours use



# PMSA 2



Relocate bus entry further north and provide additional drop-off/pick-up area for ease of access and safety

Provide open play field, walking track and tennis courts for physical education use

New, dedicated drop-off/pick-up lane lowers congestion and creates safer site circulation

New Student Commons with relocated secured entry allows for after hours use

New Performing Arts facilities. Re dedicate facilities in main building for additional classrooms



# PMSA 3

Relocate bus entry further north and provide additional drop-off/pick-up area for ease of access and safety

Provide open play field, walking track and tennis courts for physical education use

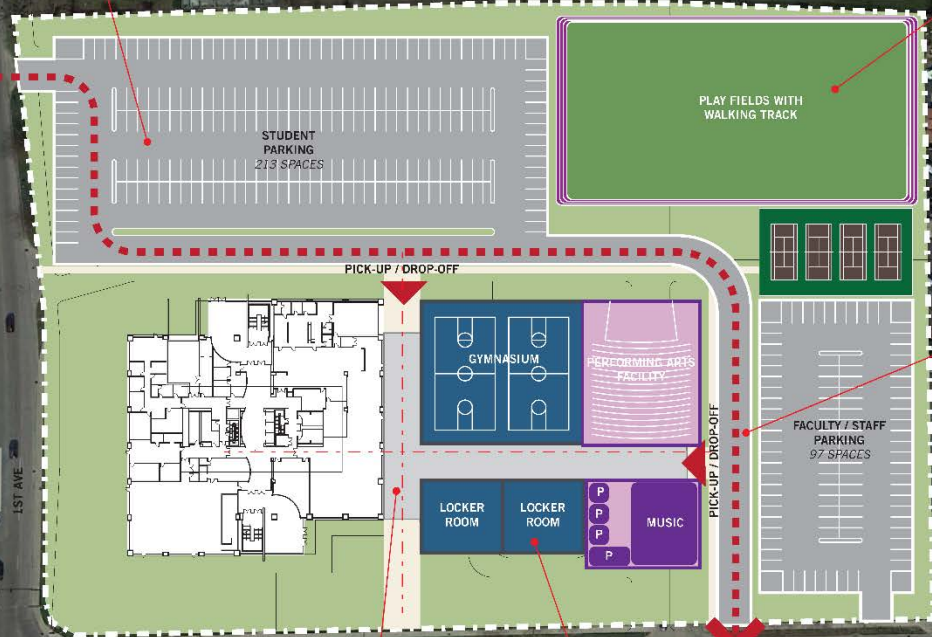

New, dedicated drop-off/pick-up lane lowers congestion and creates safer site circulation

New Student Commons with relocated secured entry allows for after hours use

New Performing Arts and PE facilities; re-locate facilities in main building for additional classrooms



# EAST EXISTING



PERKINS+WILL



PERKINS  
+WILL



# EAST 1

Renovate classrooms to improve education environment, by addressing building systems and furniture

Create Student centered Common space and new secured entries from east and west sides

Create Bus drop-off zone to improve traffic and separate from parent drop-off

Explore closure of dedicated right-of-way to improve traffic circulation and additional play fields

Relocate student and faculty/staff parking to east side of First Avenue to improve safety

Consolidate and reconstruct PE / Athletics facilities in new Fieldhouse

Renovate & Expand Family & Consumer Science/Culinary Arts facilities; provide opportunities for professional development

Reconstruct Career and Technical Education facilities with direct connection to main building

Reconstruct competition stadium & track & field facilities for improved performance and flexibility



# EAST 2

Renovate classrooms to improve education environment, by addressing building systems and furniture

Create Student centered Common space and new secured entrances from east and west sides

Create Bus drop-off lane to improve traffic and separate from parent drop-off

Consolidate & expand career technical education facilities; relocate building engineering & receiving

Relocate student and faculty/staff parking to east side of First Avenue to improve safety

Consolidate, renovate and expand PE / Athletics facilities at Fieldhouse

Renovate & Expand Family & Consumer Science/Culinary Arts facilities; provide opportunities for professional development

Reconstruct competition stadium & track & field facilities for improved performance and flexibility



# EAST 3

Renovate classrooms to improve education environment, by addressing building systems and furniture

Create Student centered Common space and new secured entries from east and west sides

Create Bus drop-off zone to improve traffic and separate from parent drop-off

Relocate PMSA to take advantage of existing common and physical education facilities

FACULTY / STAFF PARKING  
178 SPACES

PEHS ACADEMIC ADDITION CTE

FACS

FIELD HOUSE EXPANSION

STUDENT COMMONS

CAMPUS

FACULTY / STAFF PARKING  
236 SPACES

Construct new academic addition to offset area displaced by PMSA in south building

Consolidate & expand career technical education facilities

Consolidate, renovate and expand PE / Athletics facilities at Fieldhouse

Renovate & Expand Family & Consumer Science/Culinary Arts facilities; provide opportunities for professional development

Reconstruct competition stadium & track & field facilities for improved performance and flexibility

Relocate some student and faculty/staff parking to east side of First Avenue to improve safety



WEST  
EXISTING

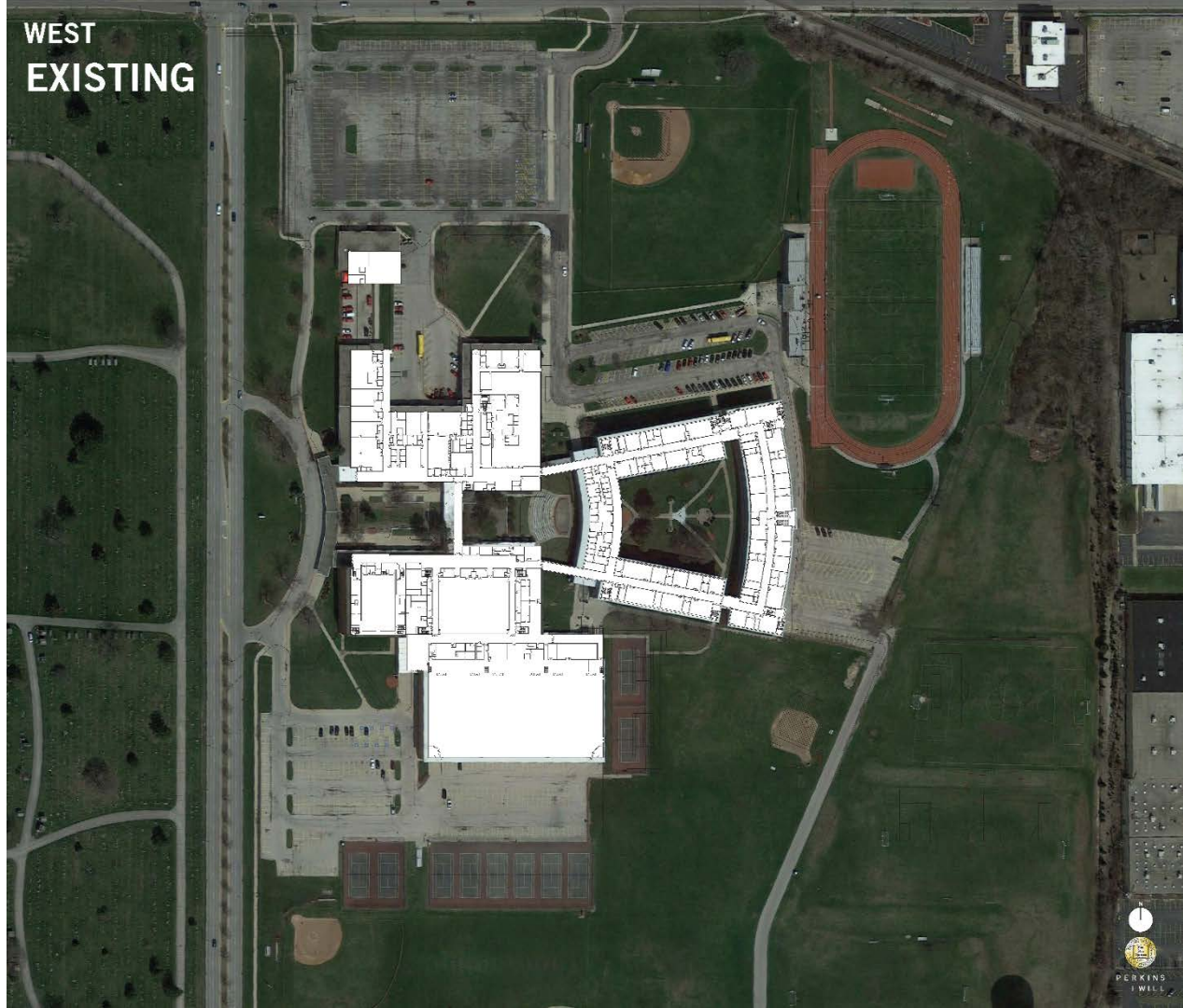

# WEST 1

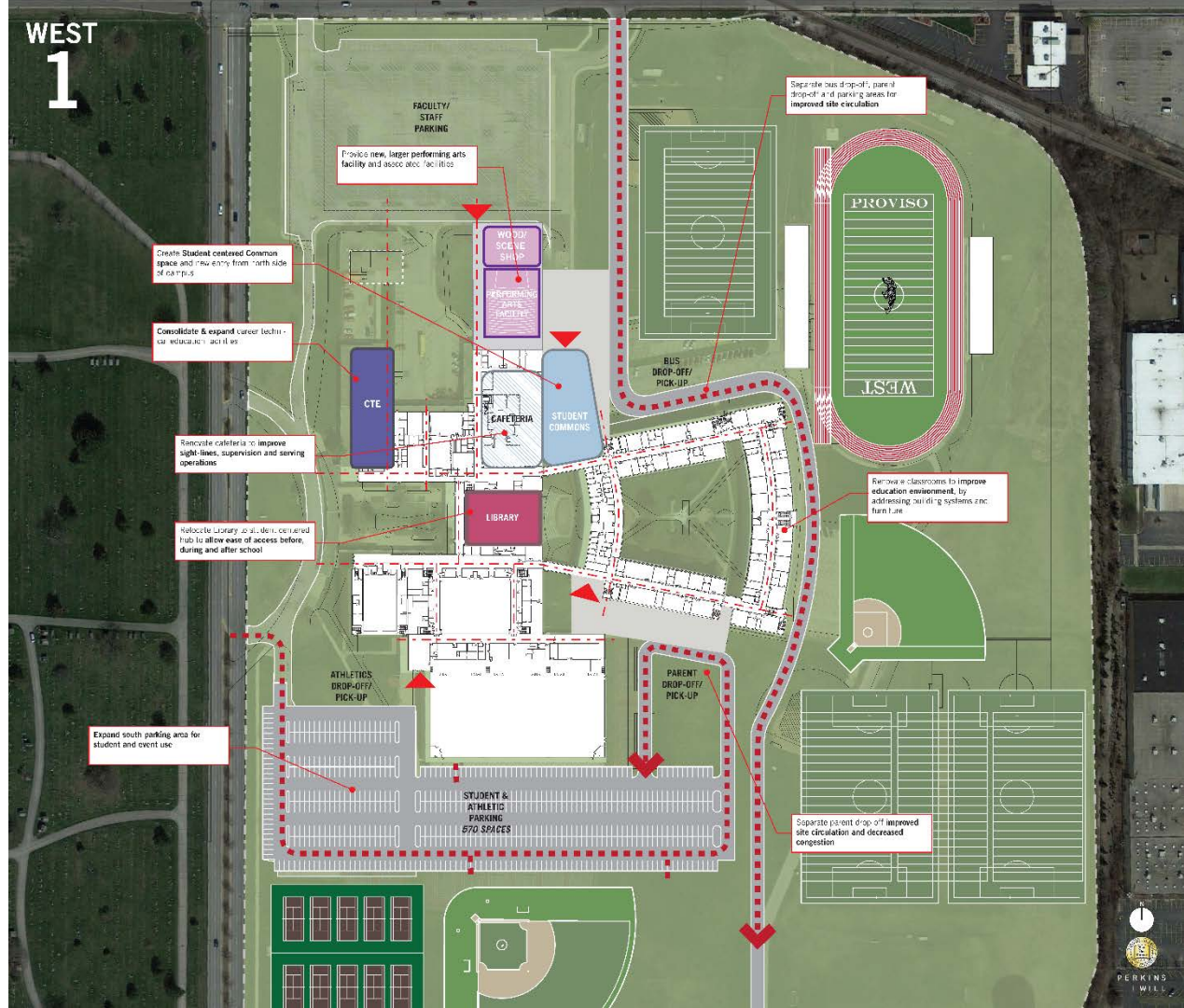

# WEST 2

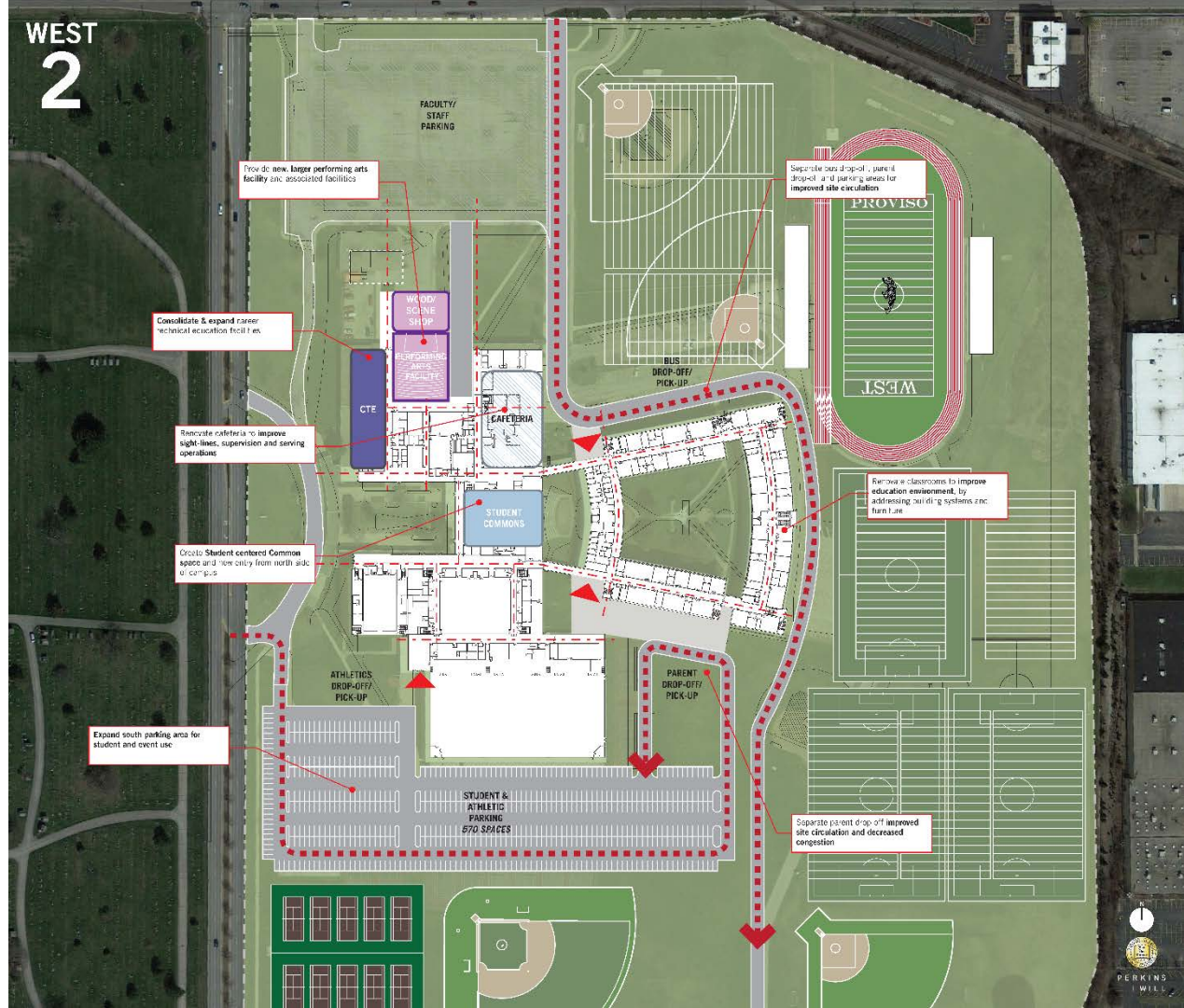

# WEST 3

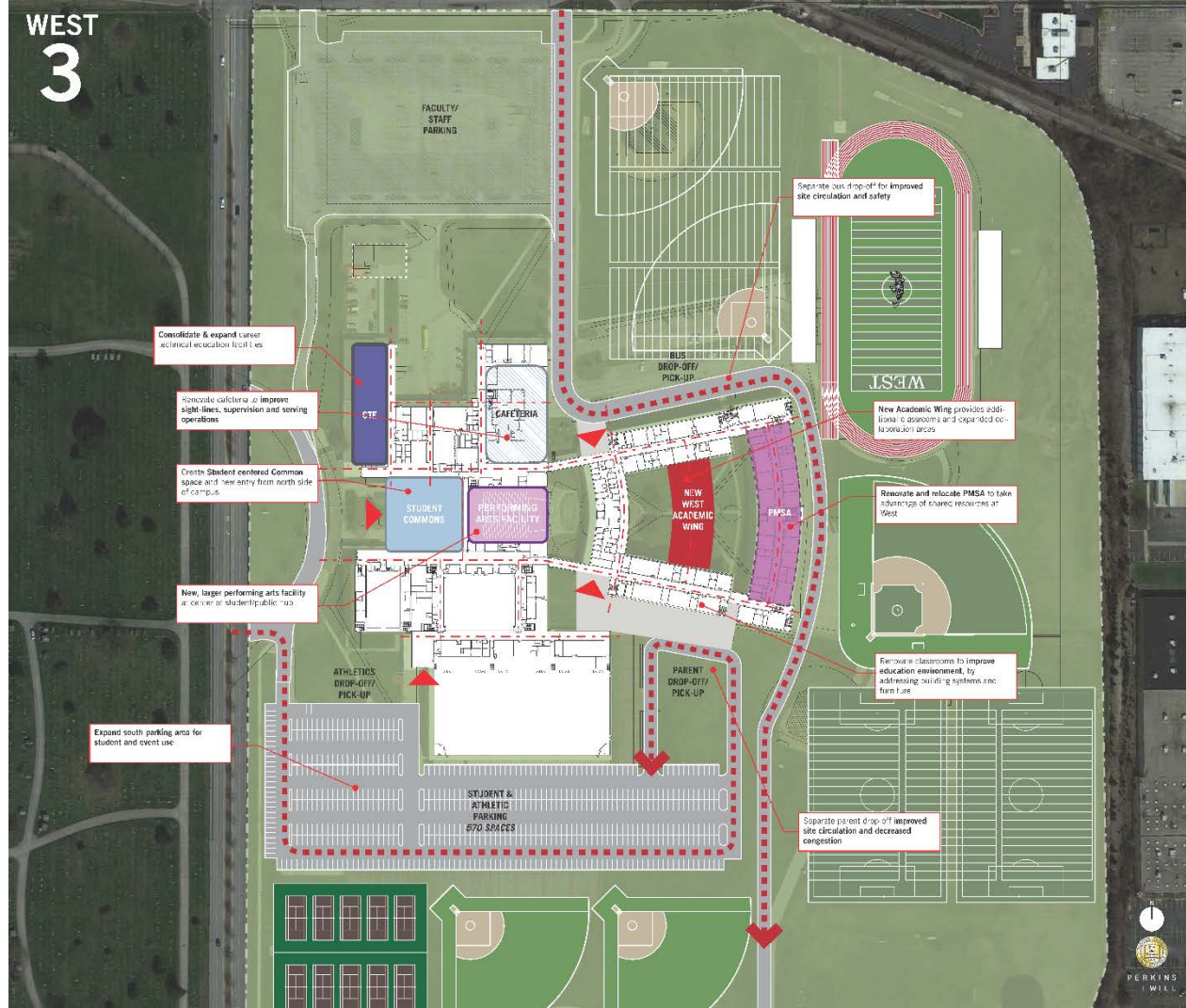

# GALLERY WALK

What you will see today

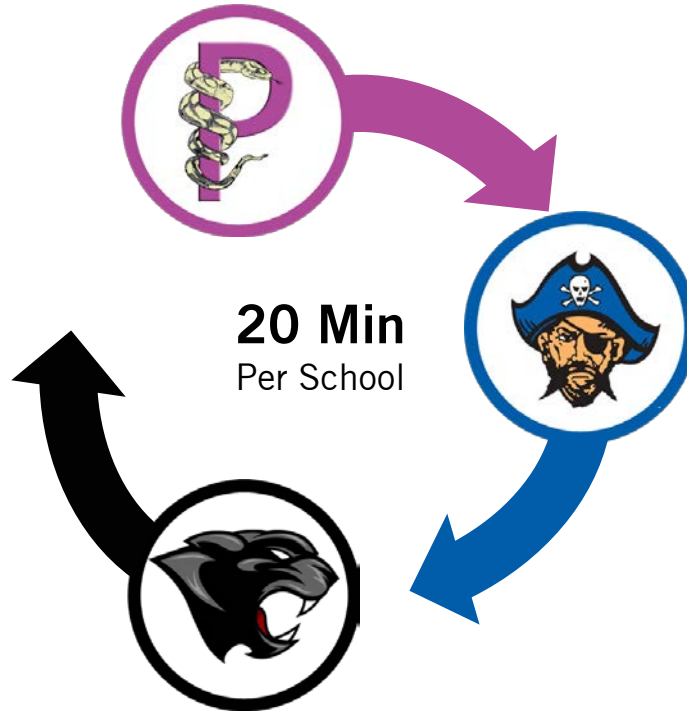

- Examine Concepts
- Ask Questions
- Provide Feedback









**05/ NEXT STEPS**

# FACILITIES MASTER PLANNING PROCESS

Revised Community Engagement Schedule

